

# MELROSE PARKLET

FOR CONSTRUCTION - 10/05/20

DRAWINGS ARE INTENDED TO BE PRINTED ON 24" X 36" PAPER

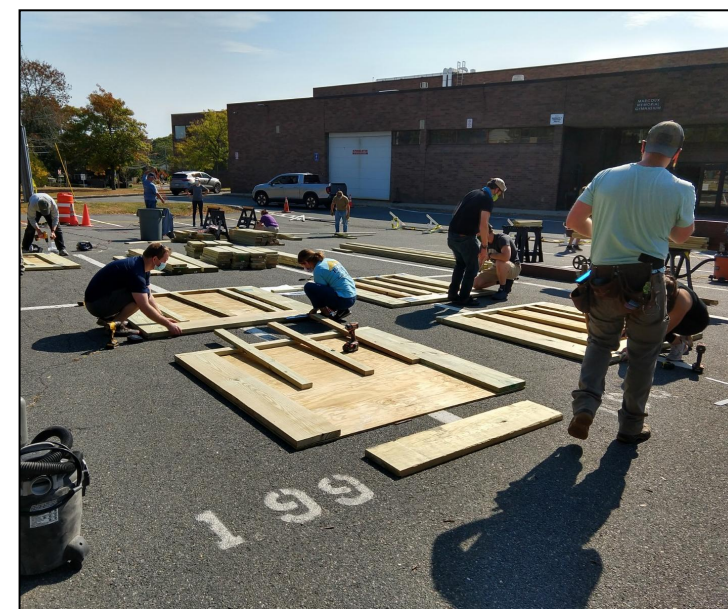

## CONSTRUCTION PROCESS

ACCESS PHOTOS AND VIDEOS OF THE VOLUNTEER CONSTRUCTION PROCESS HERE: <https://photos.app.goo.gl/vmN3usa8FbenTSUX8>



## INTRODUCTION & INDEMNIFICATION

THE DESIGN OF THE PARKLET WAS A VOLUNTEER COLLABORATION BETWEEN THE MELROSE PED & BIKE COMMITTEE AND LAMMERT DESIGN STUDIO DURING THE FALL OF 2020.

WHILE THE DESIGN WAS CUSTOMIZED TO LOCAL MELROSE CONDITIONS WE ALSO INTENDED TO USE OFF-THE-SHELF PRODUCTS THAT ARE READILY ACCESSIBLE AND APPLICABLE AS A PROTOTYPE FOR OTHER COMMUNITIES.

LAMMERT DESIGN STUDIO SHALL NOT BE HELD LIABLE FOR ANY INJURY, DAMAGES, INTERRUPTIONS, OR LOSS ARISING OUT OF THE USE OF THESE CONSTRUCTION DRAWINGS BY OTHERS TO DEVELOP THEIR OWN PARKLET STRUCTURES.

DRAWING INDEX	
A-001	COVER SHEET & OVERVIEW
A-100	PARKLET BASE DETAILS & ASSEMBLY
A-101	BASE TO PLANTER CONNECTION
A-102	PARKLET PLANTER DETAILS
A-103	MODULE CONNECTIONS & ACCOUTREMENTS

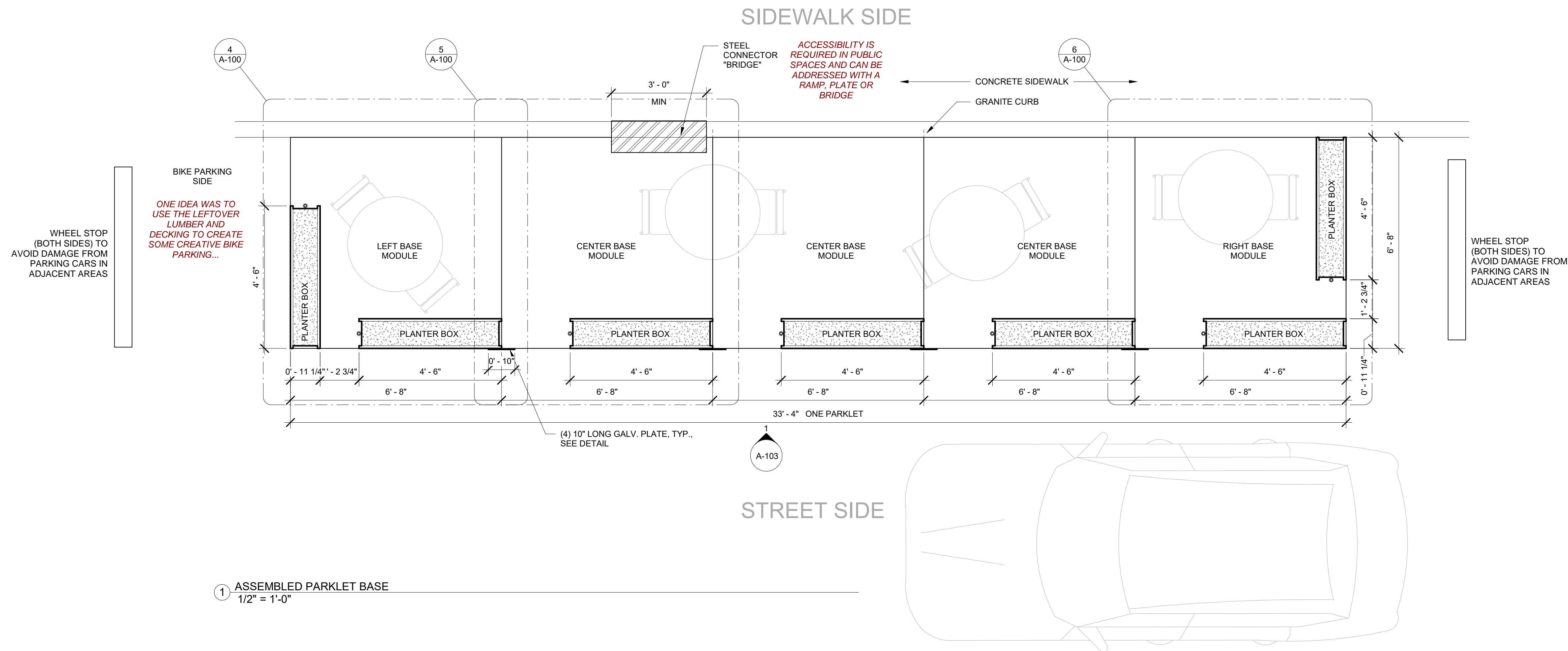

CONSTRUCTION AND FINAL PHOTOS/COMMENTARY ADDED FOR REFERENCE



### PROJECT

MELROSE PARKLET

### LEGEND

(E) EXISTING TO REMAIN
(N) NEW CONSTRUCTION

### ISSUE

SCHEMATIC DESIGN	09/01/20
PROTOTYPE CONST.	09/11/20
REVISION PROGRESS	09/30/20
FOR CONSTRUCTION	10/05/20

### NORTH ARROW

### DATE

10/5/20

### SHEET NAME

COVER SHEET & OVERVIEW

### SHEET NUMBER

A-001



APPLIES TO ALL MODULES

## STEP 1

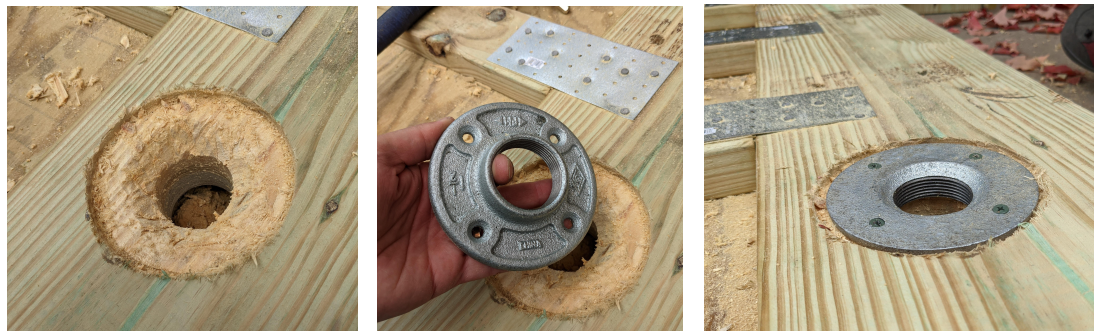

NOTE THAT ROUTERD SURFACE MUST BE LEVEL TO ENSURE THREADS ARE PERPENDICULAR TO THE BASE

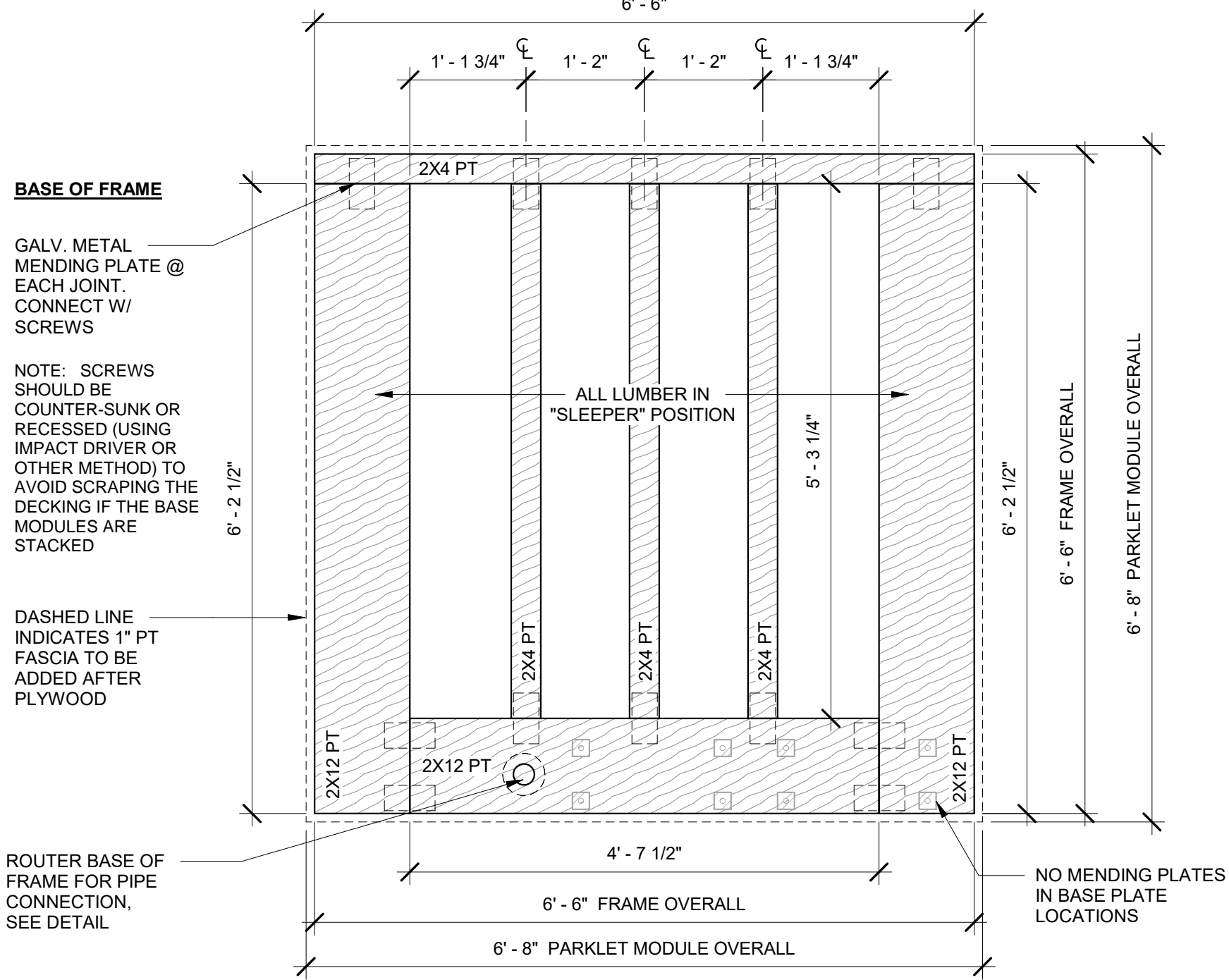

① BASE "SLEEPER FRAME"  
3/4" = 1'-0"

## STEP 2

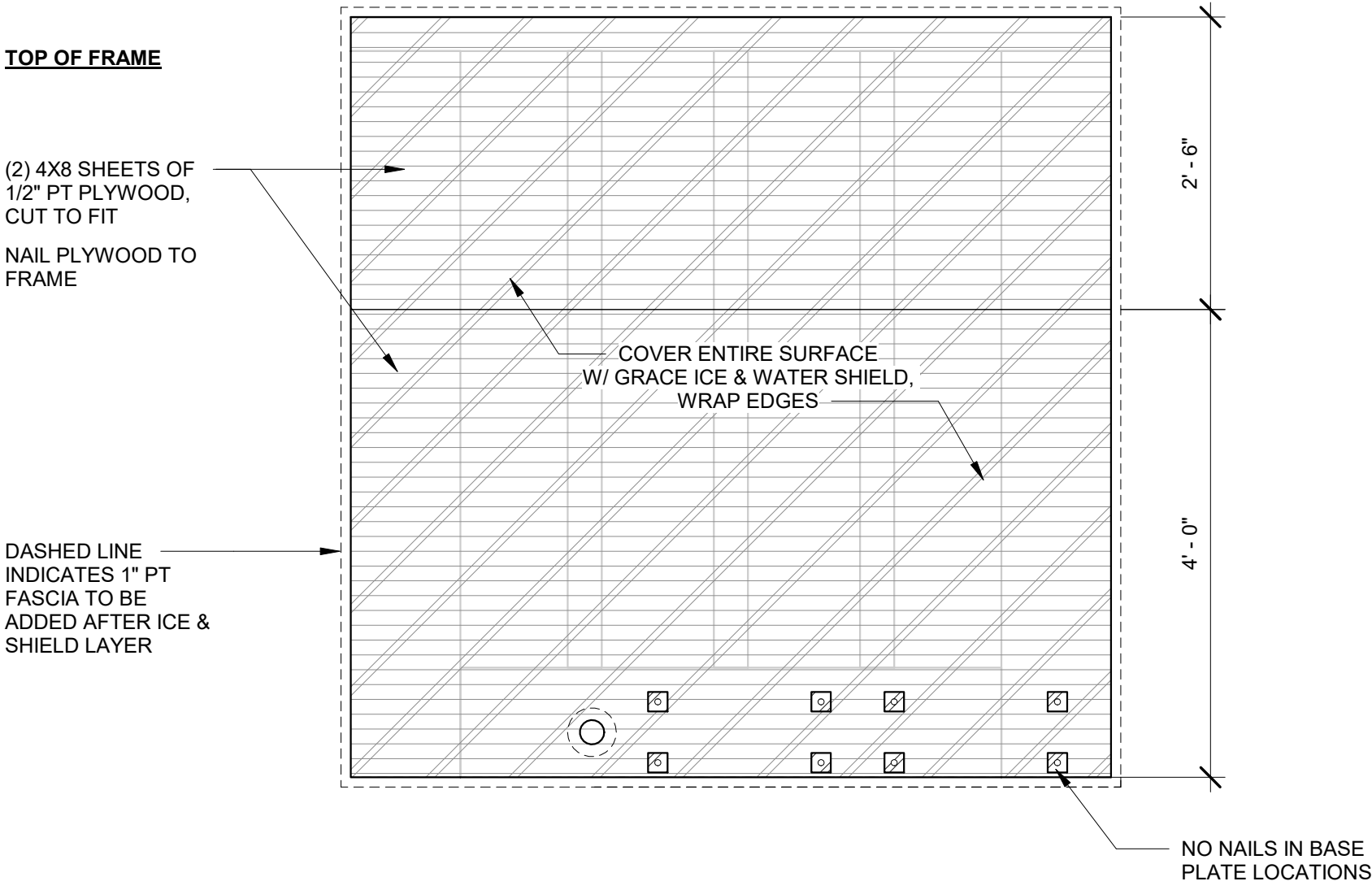

② BASE PT PLYWOOD LAYER  
3/4" = 1'-0"

## STEP 3

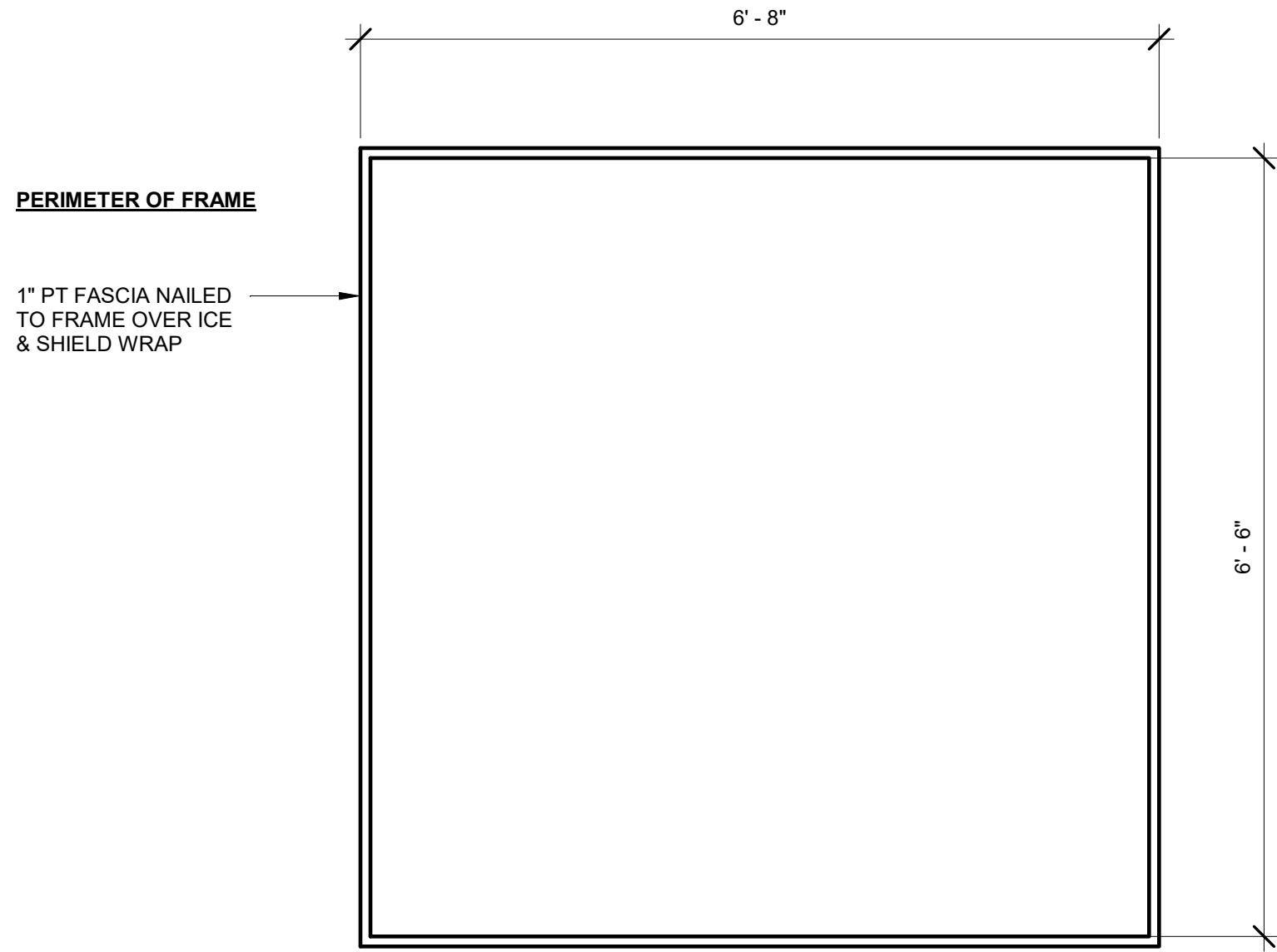

③ BASE PT FASCIA LAYER  
3/4" = 1'-0"

## STEP 4: LEFT MODULE



DETAILS LIKE A MITER AT THE CORNER REALLY HELP IT FEEL FINISHED.

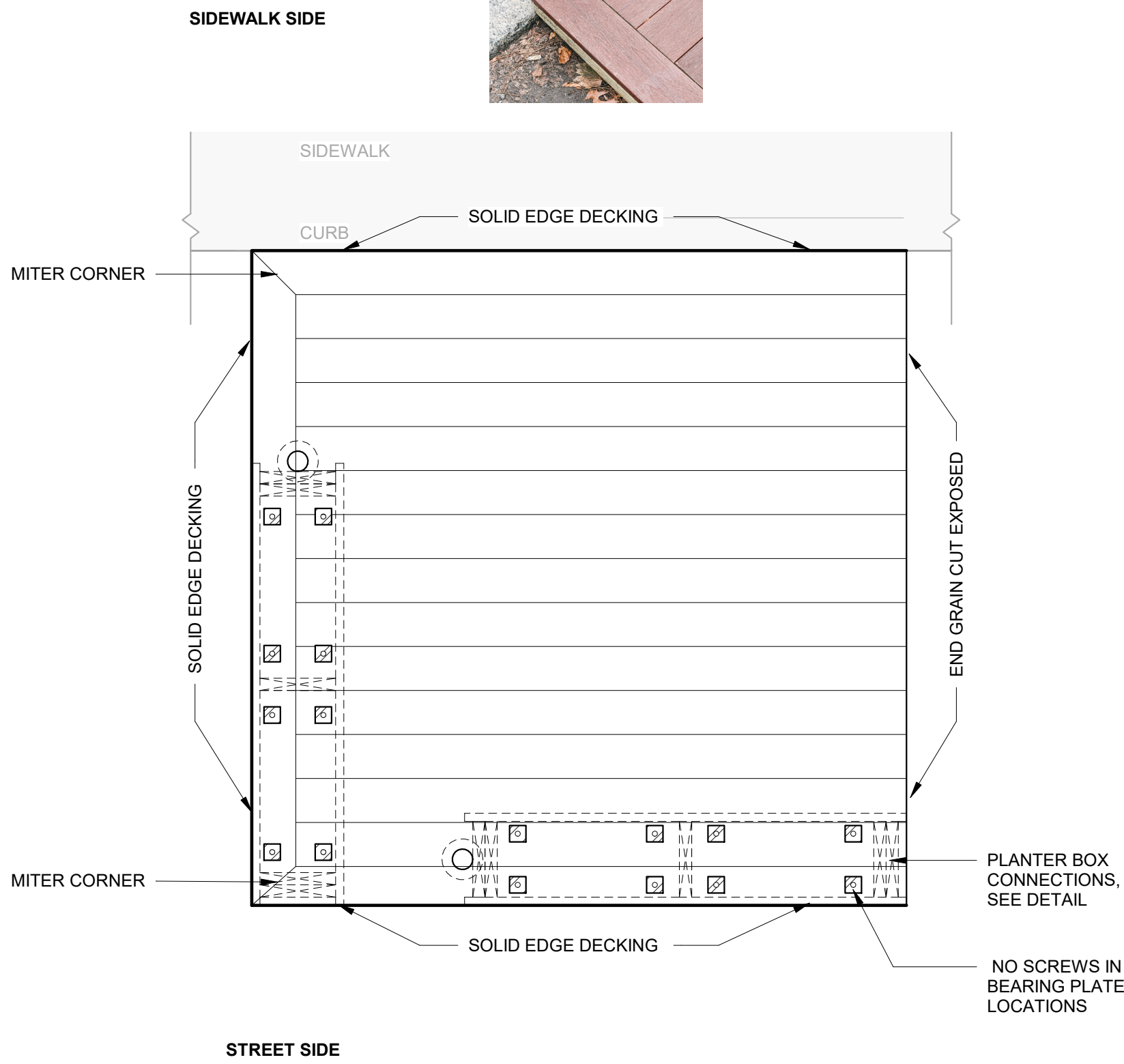

④ LEFT BASE MODULE  
3/4" = 1'-0"

## STEP 5: CENTER MODULE



WE USED THE CINNABAR DECKING COLOR BECAUSE IT RELATES TO THE COLOR TONES IN MELROSE BRICK STRUCTURES.

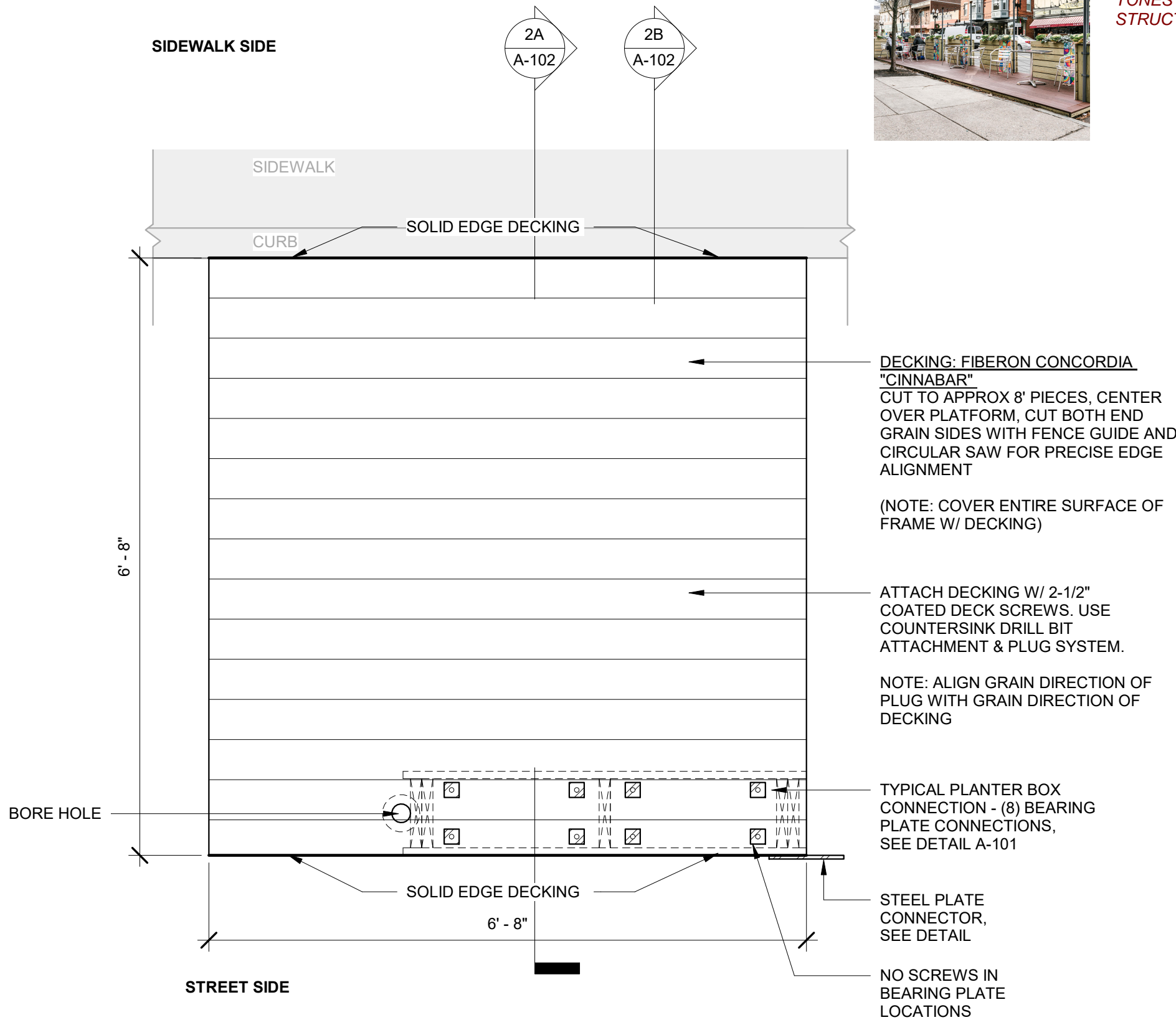

⑤ CENTER BASE MODULE  
3/4" = 1'-0"

## STEP 6: RIGHT MODULE

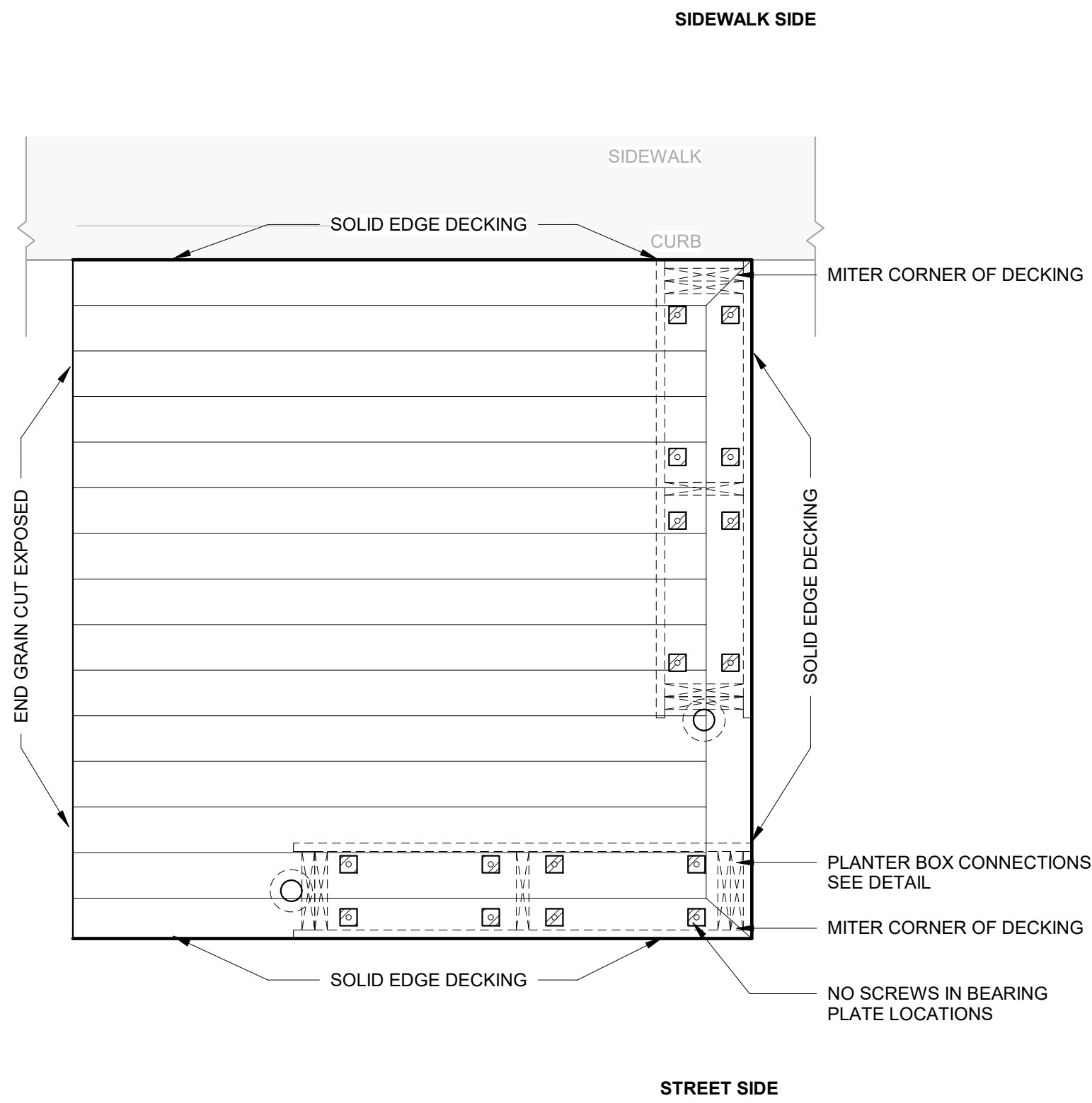

⑥ RIGHT BASE MODULE  
3/4" = 1'-0"

SPECIFIC TO LOCATION

PROJECT  
MELROSE PARKLET

LEGEND  
(E) EXISTING TO REMAIN  
(N) NEW CONSTRUCTION

ISSUE	
SCHEMATIC DESIGN	09/01/20
PROTOTYPE CONST.	09/11/20
REVISION PROGRESS	09/30/20
FOR CONSTRUCTION	10/05/20

NORTH ARROW

DATE  
10/5/20

SHEET NAME

PARKLET BASE  
DETAILS &  
ASSEMBLY

SHEET NUMBER

A-100

PROJECT

MELROSE PARKLET

LEGEND

ISSUE

SCHEMATIC DESIGN	09/01/20
PROTOTYPE CONST.	09/11/20
REVISION PROGRESS	09/30/20
FOR CONSTRUCTION	10/05/20

NORTH ARROW

DATE

10/5/20

SHEET NAME

BASE TO  
PLANTER  
CONNECTION

SHEET NUMBER

A-101

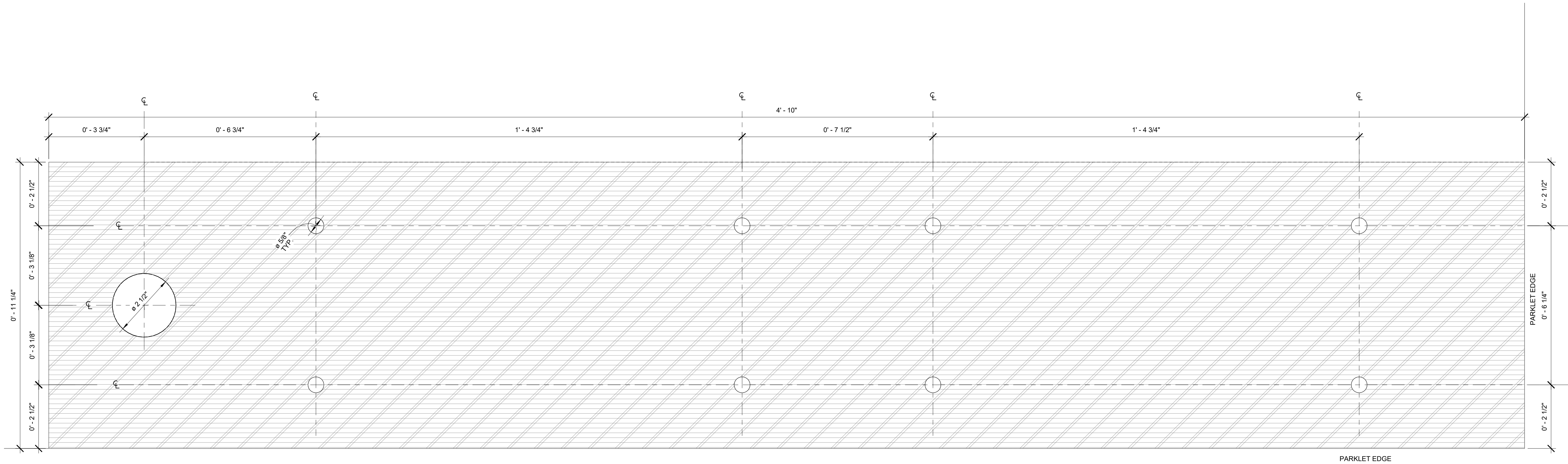

1 TEMPLATE - VIEW FROM TOP  
6" = 1'-0"

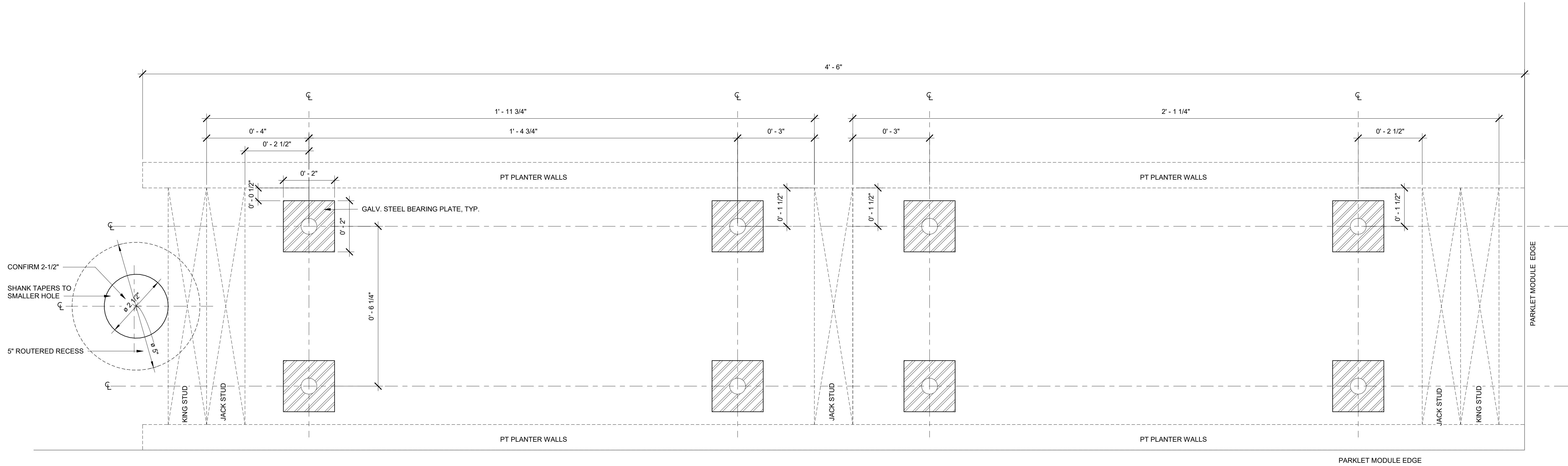

2 PLANTER CONNECTION  
6" = 1'-0"





MEASURING OUT THE LOCATION FOR THE SCREWS HELPS TO KEEP THE ASSEMBLY ORGANIZED.

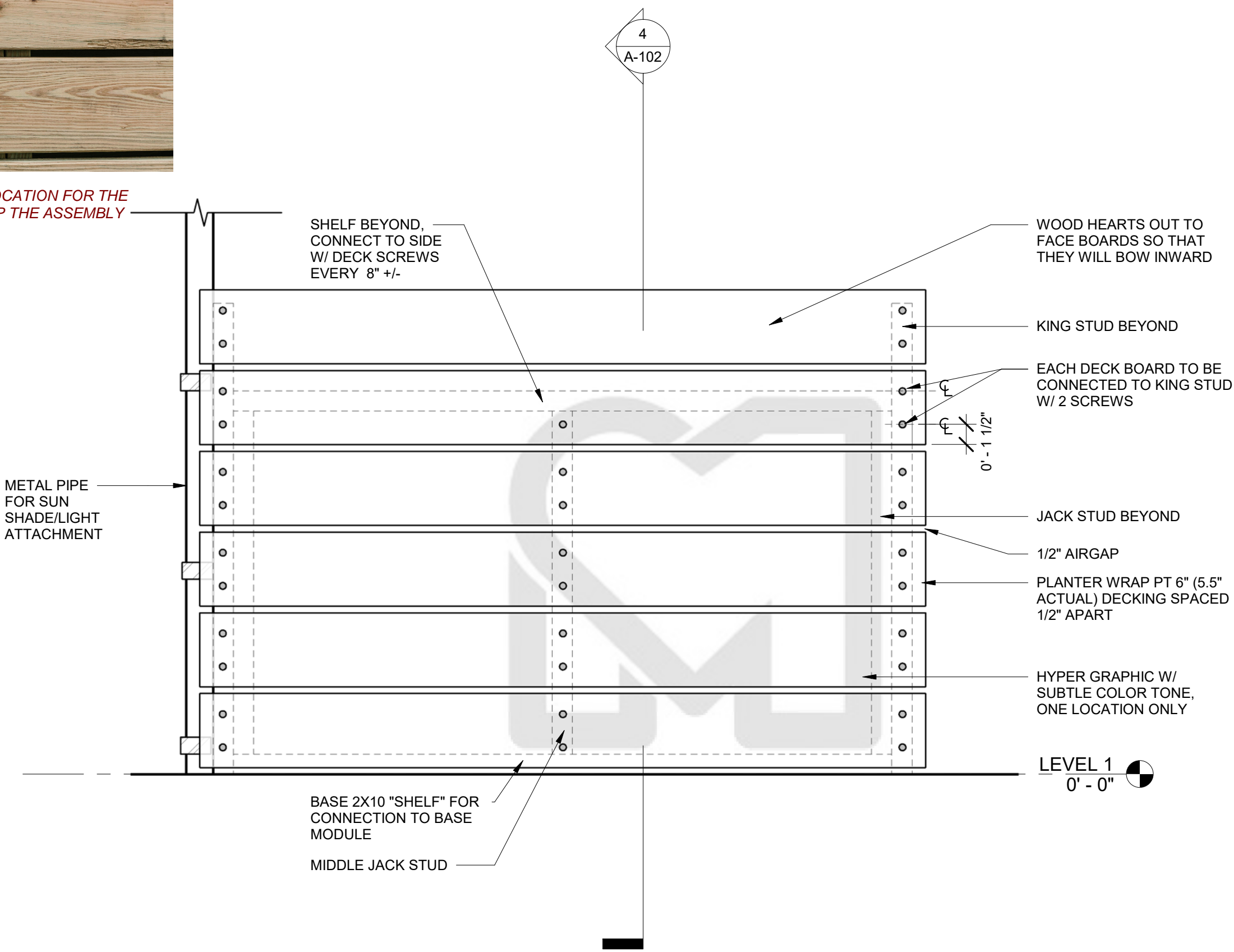

1 PLANTER ELEVATION  
1 1/2" = 1'-0"



EXAMPLE OF BASE PLATE CONNECTORS

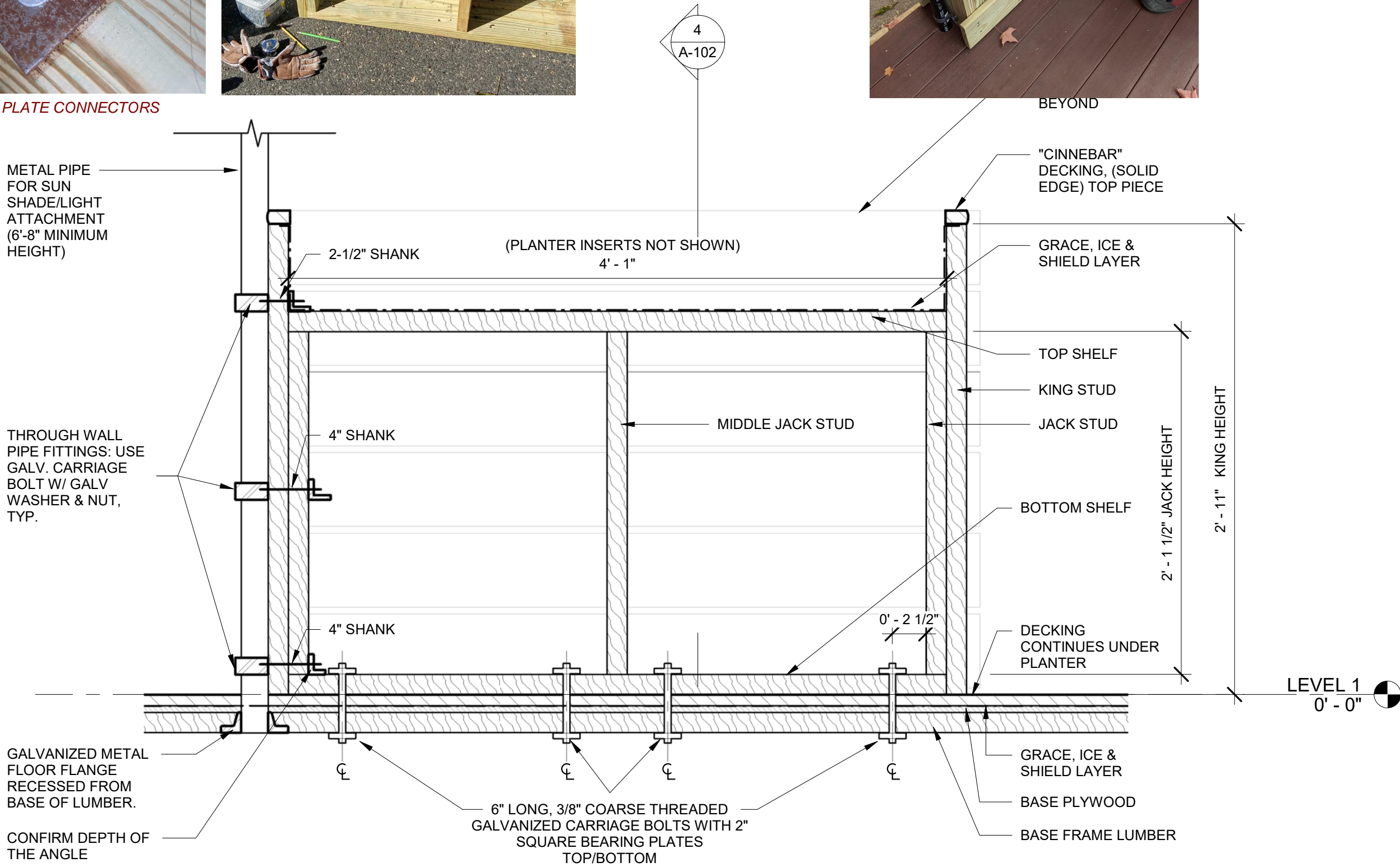

3 PLANTER BOX SECTION  
1 1/2" = 1'-0"

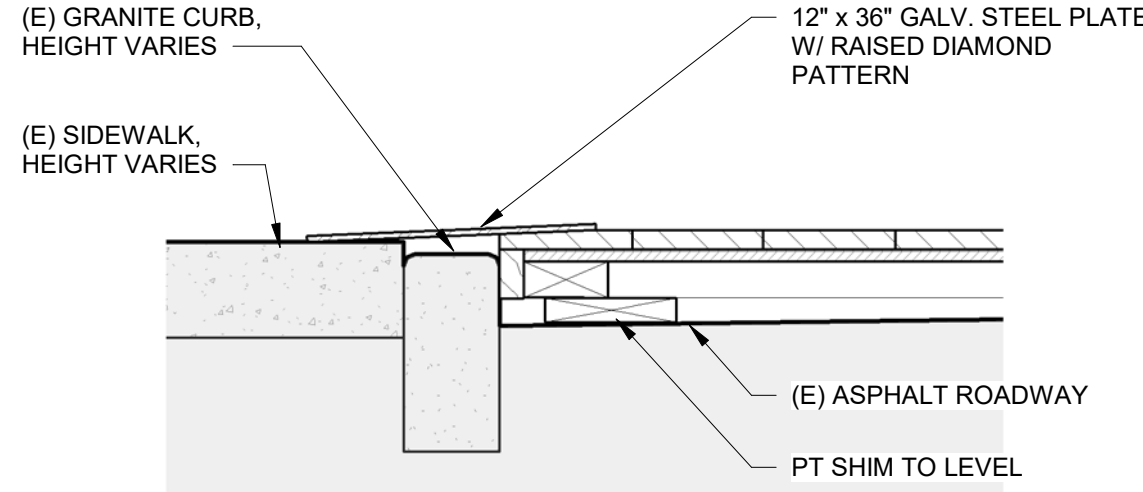

2B BASE BRIDGE DETAIL  
1 1/2" = 1'-0"



MAKING THE PARKLET ACCESSIBLE AND SAFE IS VERY IMPORTANT. SINCE CURB HEIGHTS VARY SIGNIFICANTLY, THE APPROACH (BRIDGE PLATE OR CURB) SHOULD BE CUSTOMIZED FOR EACH UNIQUE SITUATION

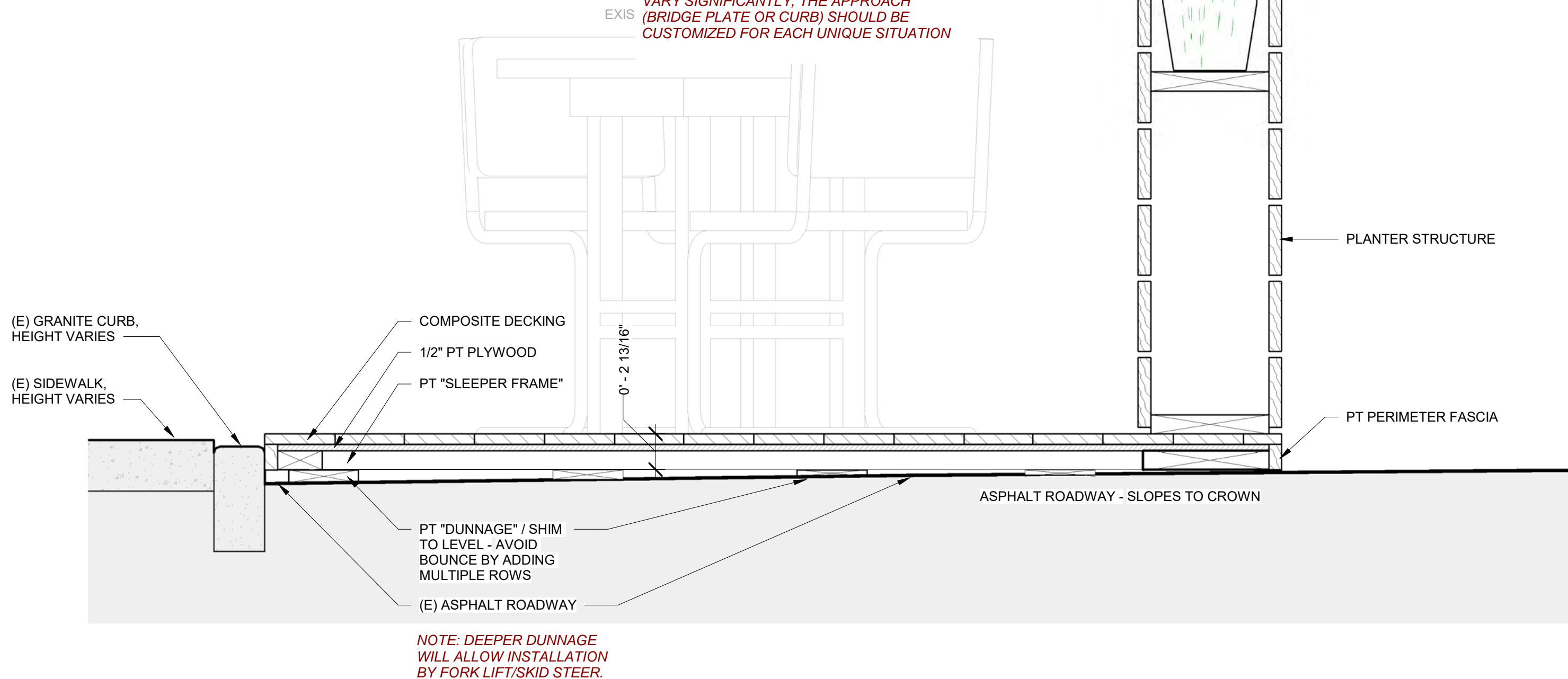

2A TYPICAL BASE MODULE SECTION  
1 1/2" = 1'-0"



LATE FALL PLANTINGS GAVE SOME LIFE TO THE BOXES

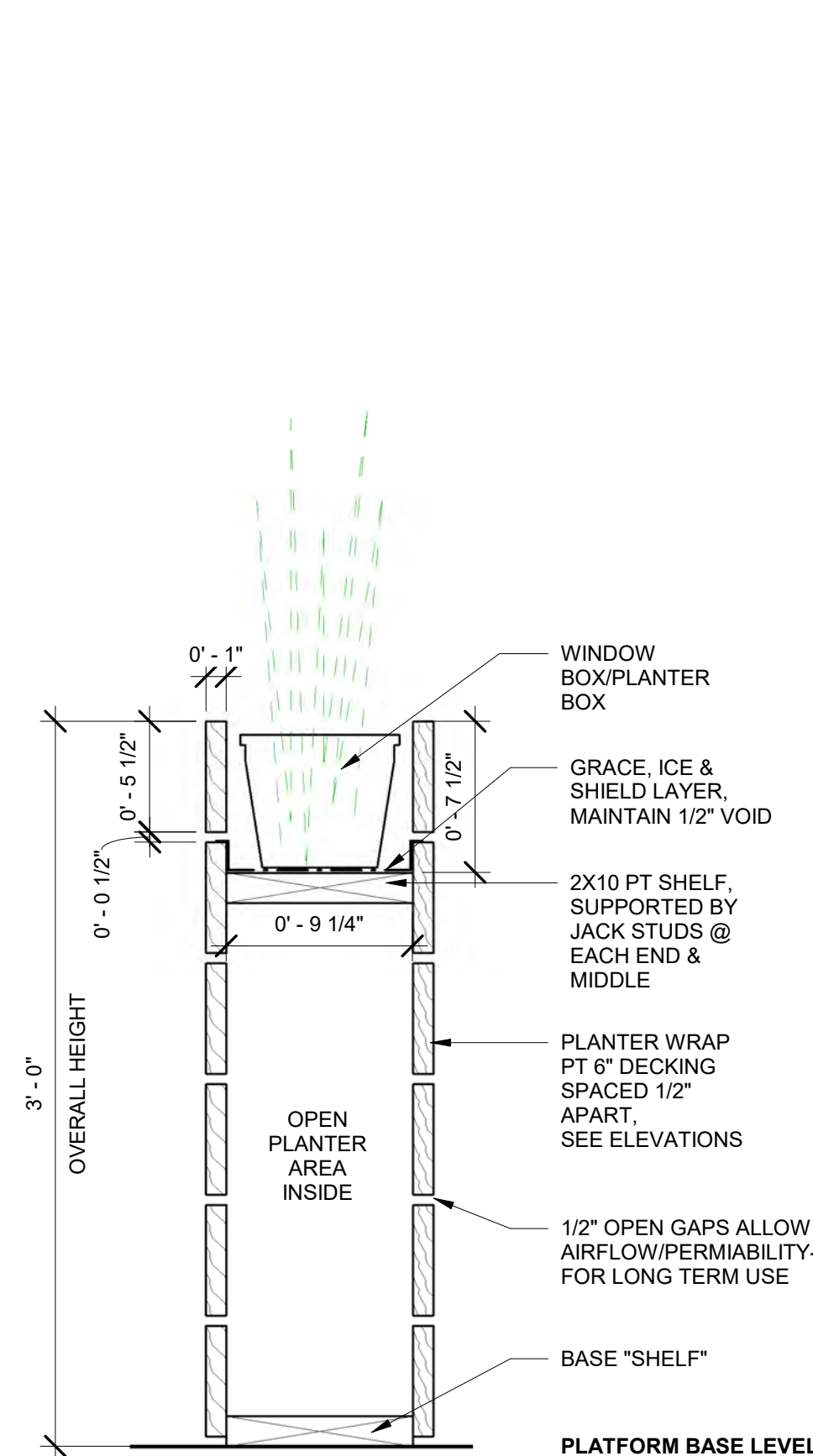

WE RECOMMEND USING SCREWS INSTEAD OF NAILS TO ASSEMBLY THE PLANTER BOXES. NAILS CAN PULL OUT WHEREAS THE THREADS OF SCREWS ARE MUCH STRONGER FOR IMPACT.

4 PLANTER CROSS SECTION  
1 1/2" = 1'-0"

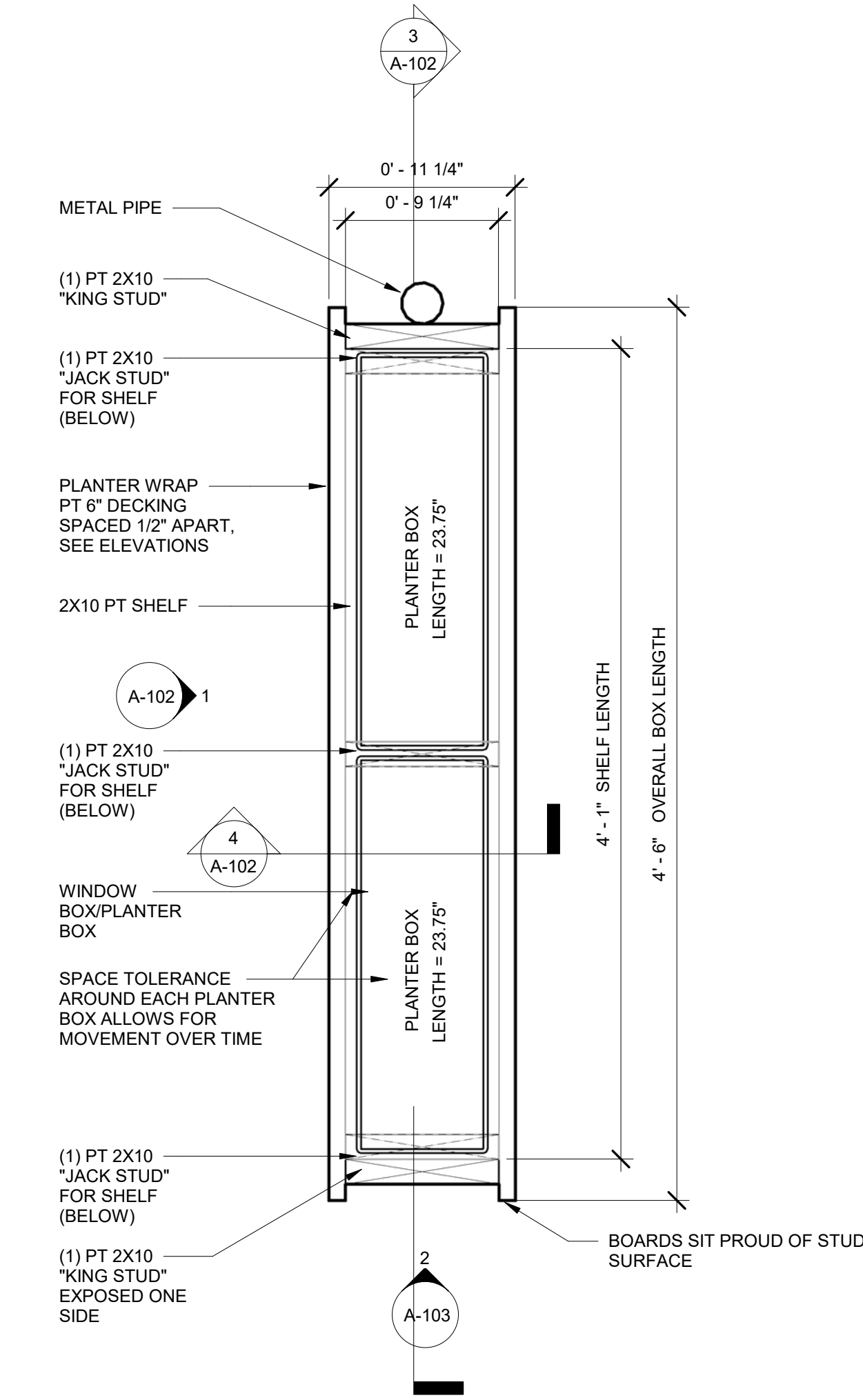

5 TYPICAL PLANTER PLAN DETAIL @ PLANT LEVEL  
1 1/2" = 1'-0"

PROJECT  
MELROSE PARKLET

LEGEND	
	(E) EXISTING TO REMAIN
	(N) NEW CONSTRUCTION

ISSUE	
SCHEMATIC DESIGN	09/01/20
PROTOTYPE CONST.	09/11/20
REVISION PROGRESS	09/30/20
FOR CONSTRUCTION	10/05/20

NORTH ARROW

DATE  
10/5/20

SHEET NAME

PARKLET PLANTER DETAILS

SHEET NUMBER

A-102





A-103